

## First Look: Inside the New Amenity Spaces and Penthouse at The Parker in Boston

The 22-story condo unveiled its amenity collection and forthcoming \$2.8 million penthouse listing.

By ABBY MONTANEZ 

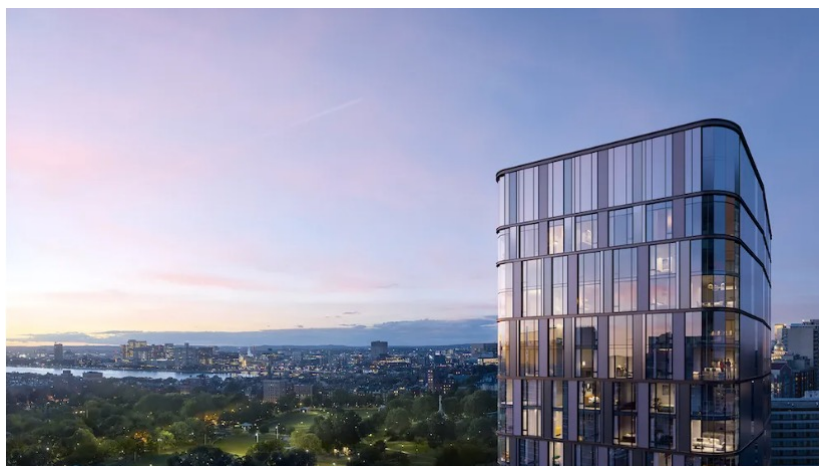

The Parker made waves earlier this year as Boston's first-ever fully-furnished, turnkey residential tower. And now, *Robb Report* has an exclusive first look at the design of the development's swanky new amenity spaces and a sneak peek at its forthcoming \$2.8 million penthouse.

Located in the city's historic Theater District, the resort-like building was designed by architecture firm Stantec and overlooks Boston Common. Altogether, it features 168 units ranging from studios to two-bedroom homes, with prices starting at \$600,000 and reaching \$3 million. The move-in-ready residences have been thoughtfully curated by Linda Zarifi of Zarifi Design, and buyers have the option of purchasing a collection of bespoke, limited-edition furnishings, with packages starting at \$35,000.



A sneak peek of a fully-furnished, not-yet-listed penthouse at The Parker in Boston.  
SURETTE MEDIA GROUP

The soon-to-be-listed Penthouse 21D includes soaring nine-foot ceilings, oversized windows, five-inch-wide oak floorboards, and 1,268 square feet of living space. The kitchen is decked out with custom brass pendant light fixtures, Calacatta Quartz countertops, Fior Di Bosco marble backsplash, Mocaccino cabinetry, and top-of-the-line Thermador and Bosch appliances. Elsewhere, the bathrooms are adorned with marble floors, herringbone-tiled shower walls, and micro-penny-tiled shower floors.

Residents of The Parker will have access to a whopping three floors of amenities, including the first-ever standalone condo gym designed by Gronk Fitness, former NFL star Rob Gronkowski's family's line of high-end fitness equipment. Naturally, the 1,300-square-foot complex was modeled after professional training facilities and takes cues from NCAA Division I athletic centers.



The 22-story building's three floors of amenity spaces include the Cue Room.  
SURETTE MEDIA GROUP

The building's other amenity spaces are inspired by the world's most exclusive (and super chic) members-only clubs. For example, take the Rose Lounge, a speakeasy-style brass bar, or the Cue Room, a billiards area with a metallic drum shade chandelier. There's also the Velvet Room, a Bordeaux-colored movie theater, and The Vue, a roof deck with views of the Charles River and Boston's Financial District.

*Click [here](#) to see all the photos of The Parker.*

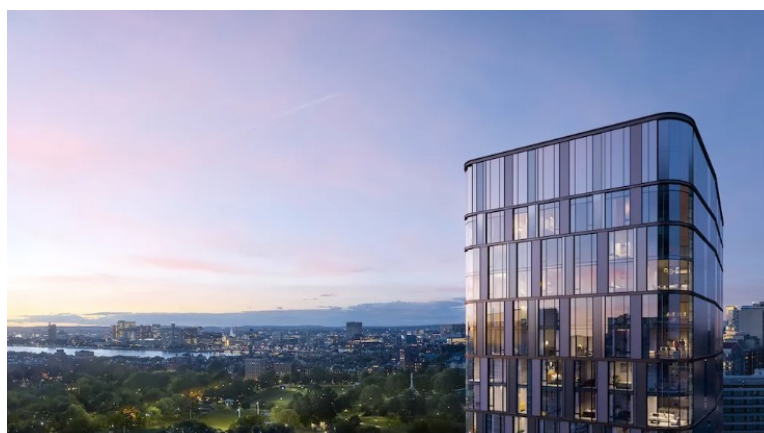



The lobby lounge at The Parker.



A studio condo.



Studios start at \$600,000.





The penthouse has two bedrooms and two bathrooms.



The living room of a soon-to-be-listed \$2.8 million penthouse with panoramic city views.



The kitchen features brass finishes and quartz counters.



It measures 1,268 square feet.



One of the two bedrooms.



The Cue Room.



The Velvet Room.



The Sculpt Fitness Center features workout equipment from Gronk Fitness.



The Vue roof deck.